

STAINLESS STEEL 316L PRESS FIT FITTINGS (M PROFILE)

COMPLY WITH BSEN1254-2:1998
AS 3688:2005
AS/NZS 4020:2005
ASTM E1086:2014
SS 375:2015
SS 270:2015

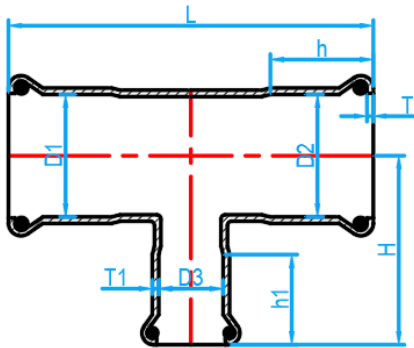

REDUCING TEE

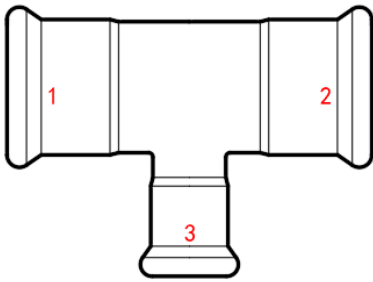

CROSS SECTIONAL VIEW

DIMENSIONS

SKU	D1×D2×D3 (mm)	L (mm)	H (mm)	h (mm)	h1 (mm)	T (mm)	T1 (mm)	WEIGHT (kg)	PCS/ CTN
SS316LPFNRT0202015	22×22×15	79	38	21	20	1.5	1.5	0.090	120
SS316LPFNRT0252515	28×28×15	88	42	23	20	1.5	1.5	0.118	60
SS316LPFNRT0252520	28×28×22	88	43	23	21	1.5	1.5	0.134	60
SS316LPFNRT0353515	35×35×15	101	45	26	20	1.5	1.5	0.170	80
SS316LPFNRT0353520	35×35×22	101	46	26	21	1.5	1.5	0.178	80
SS316LPFNRT0353525	35×35×28	101	47	26	23	1.5	1.5	0.191	50
SS316LPFNRT0424215	42×42×15	119	50	31	20	1.5	1.5	0.225	51
SS316LPFNRT0424220	42×42×22	119	51	31	21	1.5	1.5	0.244	70
SS316LPFNRT0424225	42×42×28	119	52	31	23	1.5	1.5	0.255	60
SS316LPFNRT0424235	42×42×35	119	55	31	26	1.5	1.5	0.263	50
SS316LPFNRT0505015	54×54×15	143	55	36	20	1.5	1.5	0.330	38
SS316LPFNRT0505020	54×54×22	143	57	36	21	1.5	1.5	0.346	32
SS316LPFNRT0505025	54×54×28	143	58	36	23	1.5	1.5	0.358	32
SS316LPFNRT0505035	54×54×35	143	60	36	26	1.5	1.5	0.348	32
SS316LPFNRT0505042	54×54×42	143	66	36	31	1.5	1.5	0.370	32
SS316LPFNRT0656515	67×67×15	203	64	50	20	2.0	1.5	0.700	15
SS316LPFNRT0656520	67×67×22	203	66	50	21	2.0	1.5	0.700	15
SS316LPFNRT0656525	67×67×28	203	67	50	23	2.0	1.5	0.700	15
SS316LPFNRT0656535	67×67×35	203	71	50	26	2.0	1.5	0.800	15
SS316LPFNRT0656542	67×67×42	203	76	50	31	2.0	1.5	0.765	15
SS316LPFNRT0656550	67×67×54	203	82	50	36	2.0	1.5	0.800	12
SS316LPFNRT0808020	76×76×28	230	72	51	21	2.0	1.5	0.925	12
SS316LPFNRT0808025	76×76×28	230	72	51	23	2.0	1.5	0.925	12
SS316LPFNRT0808035	76×76×35	230	75	51	26	2.0	1.5	0.955	12
SS316LPFNRT0808042	76×76×42	230	80	51	31	2.0	1.5	0.970	11
SS316LPFNRT0808050	76×76×54	230	85	51	36	2.0	1.5	0.990	10
SS316LPFNRT0808065	76×76×67	230	103	51	50	2.0	2.0	1.100	10
SS316LPFNRT10010020	108×108×22	306	88	75	21	2.0	1.5	1.700	4
SS316LPFNRT10010025	108×108×28	306	88	75	23	2.0	1.5	1.720	4
SS316LPFNRT10010035	108×108×35	306	91	75	26	2.0	1.5	1.762	4
SS316LPFNRT10010042	108×108×42	306	96	75	31	2.0	1.5	1.796	4
SS316LPFNRT10010050	108×108×54	306	101	75	36	2.0	1.5	1.818	4
SS316LPFNRT10010065	108×108×67	306	119	75	50	2.0	2.0	1.886	3
SS316LPFNRT10010080	108×108×76	306	127	75	51	2.0	2.0	1.935	3